

SETRON, switch disconnecter 3LD, EMERGENCY OFF switch, 3-pole, Iu: 32 A, Operating power / at AC-23 A at 400 V: 11.5 kW, floor mounting with door coupling, defeatable knob-operated mechanism, red/yellow, 4-hole mounting of the handle



| Model | |
|--|-------------------------------------|
| Product brand name | SETRON |
| Product designation | 3LD Switch disconnecter |
| Design of the product | EMERGENCY-STOP switch |
| Display version / for switch position indicator manual operation | 1 ON - 0 OFF |
| Design of the operating mechanism | selector switch |
| Design of handle | knob-operated mechanism, red/yellow |
| Type of the driving mechanism / motor drive | No |
| General technical data | |
| Number of poles | 3 |
| Type of device | fixed mounting |
| Type of switch | Floor mounting with door coupling |
| Size of switch disconnecter | 2 |
| Operating frequency / maximum | 50 1/h |
| Voltage | |
| Insulation voltage / rated value | 690 V |
| Surge voltage resistance / rated value | 6 kV |

| Protection class | |
|---|---------|
| Protection class IP | IP65 |
| Protection class IP / on the front | IP65 |
| Dissipation | |
| Power loss [W] / for rated value of the current / at AC / in hot operating state / per pole | 1.8 W |
| Electricity | |
| Current / at AC / rated value | 32 A |
| Continuous current / rated value | 32 A |
| Continuous current / of upstream fuse / rated value | 40 A |
| Short-time current resistance (I _{cw}) / at 690 V / limited to 1 s / rated value | 640 A |
| Main circuit | |
| Operating frequency | |
| • initial value | 50 Hz |
| • Full-scale value | 60 Hz |
| Operating power | |
| • at AC-23 A / at 400 V / rated value | 11.5 kW |
| • at AC-23 A / at 690 V / rated value | 11.5 kW |
| • at AC-3 / at 400 V / rated value | 9.5 kW |
| • at AC-3 / at 690 V / rated value | 9.5 kW |
| Operating voltage | |
| • at AC / at 50/60 Hz / rated value | 690 V |
| Auxiliary circuit | |
| Number of CO contacts / for auxiliary contacts | 0 |
| Number of NC contacts / for auxiliary contacts | 0 |
| Number of NO contacts / for auxiliary contacts | 0 |
| Operating voltage / of auxiliary contacts / at AC / maximum | 500 V |
| Continuous current / of the auxiliary contact / rated value | 10 A |
| Insulation voltage / of the auxiliary switch / rated value | 500 V |
| Suitability | |
| Suitability for use | |
| • Main switch | Yes |
| • switch disconnector | Yes |
| • EMERGENCY OFF switch | Yes |
| • safety switch | Yes |
| • maintenance/repair switch | Yes |
| Product details | |

| | |
|---|------|
| Product feature / interlock | Yes |
| Number of bracket locks / maximum | 3 |
| Hasp thickness / of bracket locks / minimum | 4 mm |
| Hasp thickness / of bracket locks / maximum | 6 mm |
| Product extension / optional | |
| • motor drive | No |
| • Voltage trigger | No |

Short circuit

| | |
|--|-------|
| Conditional short-circuit current / with line-side fuse protection | |
| • at 690 V / by gG fuse / rated value | 50 kA |

Connections

| | |
|---|--|
| Type of connectable conductor cross-sections | |
| • for copper conductor / solid | 1x (1,516mm ²) |
| • for copper conductor / finely stranded / with core end processing | 1x (1,510mm ²) |
| • for copper conductor / stranded | 1x (1,516mm ²) |
| • for auxiliary contacts / solid | 2x (0.75 ... 2.5 mm ²), 1x 4 mm ² |
| • for auxiliary contacts / finely stranded / with core end processing | 2x (0.75 ... 1.5 mm ²), 1x 2.5 mm ² |
| • for auxiliary contacts / stranded | 2x (0.75 ... 2.5 mm ²), 1x 4 mm ² |
| Type of electrical connection | |
| • for main current circuit | box terminal |
| • for auxiliary contacts | connection terminals |

Requirements

| | |
|---|------------------|
| Design of the fuse link | |
| • for short-circuit protection of the main circuit / required | fuse gL/gG: 40 A |
| • for short-circuit protection of the auxiliary switch / required | fuse gL/gG: 10 A |

Mechanical Design

| | |
|--|-------------------------------------|
| Height | 79 mm |
| Width | 67 mm |
| Depth | 385 mm |
| Mounting type | Built-in unit fixed-mounted version |
| Mounting type | |
| • front mounting with 4-hole attachment | Yes |
| • front mounting with central attachment | No |
| • rail mounting | Yes |
| Net weight | 391 g |

Environmental conditions

| | |
|--|--------|
| Ambient temperature | |
| <ul style="list-style-type: none"> during operation / minimum | -25 °C |
| <ul style="list-style-type: none"> during operation / maximum | 55 °C |

Certificates

| | |
|--|----|
| Reference code | |
| <ul style="list-style-type: none"> acc. to DIN EN 61346-2 | S |
| <ul style="list-style-type: none"> acc. to DIN EN 81346-2 | SF |

Waste electronic equipment must not be disposed as unsorted municipal waste, e.g. household waste. For disposing the waste electronic equipment it is necessary to observe the current local national/international regulations.



| | |
|---------------------------------|----------------------------------|
| General Product Approval | Declaration of Conformity |
|---------------------------------|----------------------------------|



[Miscellaneous](#)



| | | |
|--------------------------|--------------------------|--------------|
| Test Certificates | Shipping Approval | other |
|--------------------------|--------------------------|--------------|

[Special Test Certificate](#)



LRS

[Environmental Confirmations](#)

Further information

Information- and Downloadcenter (Catalogs, Brochures,...)

<http://www.siemens.com/lowvoltage/catalogs>

Industry Mall (Online ordering system)

<https://mall.industry.siemens.com/mall/en/en/Catalog/product?mlfb=3LD2217-0TK13>

Service&Support (Manuals, Certificates, Characteristics, FAQs,...)

<https://support.industry.siemens.com/cs/ww/en/ps/3LD2217-0TK13>

Image database (product images, 2D dimension drawings, 3D models, device circuit diagrams, ...)

http://www.automation.siemens.com/bilddb/cax_en.aspx?mlfb=3LD2217-0TK13

CAX-Online-Generator

<http://www.siemens.com/cax>

Tender specifications

<http://www.siemens.com/specifications>

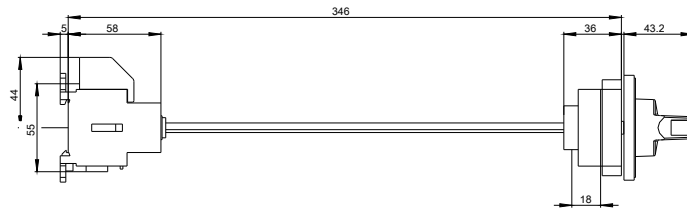
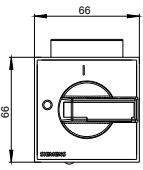

Tuer/ Door/ Porte Boden/ Base/ Plancher/
Puerta/ Porta/ Porta Base/ Pavimento/ Fundo

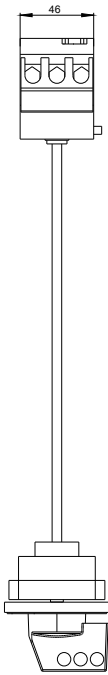
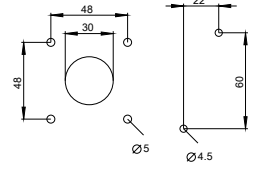

-Q1



-CI

